

## PIPER PA-23-250 C-F AZTEC WITH LYCOMING IO-540 ENGINE

Item	Part Number	Description	Code
1	28279-002	FRONT OUTBOARD RIGHT ENGINE	
2	28279-003	REAR OUTBOARD RIGHT ENGINE	
3	28279-014	CROSSOVER RIGHT ENGINE	
4	33420-002	STACK INBOARD RIGHT ENGINE	
5	28278-002	FRONT OUTBOARD LEFT ENGINE	
6	28278-003	REAR OUTBOARD LEFT ENGINE	
7	28278-012	CROSSOVER LEFT ENGINE	
8	33419-003	STACK INBOARD LEFT ENGINE	
9	760-702	BRACKET ASSY HANGAR KIT	
10	14235-002	EXHAUST STACK SUPPORT CLAMP	
11	14235-013	SHROUD TAKEOFF CLAMP	D
11	14235-018	SHROUD TAKEOFF CLAMP	E
12	32217-000	SHROUD TAKEOFF ASSY	
13	32275-000	SHROUD CLAMP	D
13	32275-003	SHROUD CLAMP	E
14	33178-002	SHROUD TOP	D
14	33178-004	SHROUD TOP	E
15	33178-003	SHROUD BOTTOM	D
15	33178-005	SHROUD BOTTOM	E
16	40123-100	SHROUD SAFETY CABLE	
17	33419-002	STACK OUTBOARD LEFT ENGINE	
18	33420-003	STACK OUTBOARD RIGHT ENGINE	
19	31212-002	CROSSOVER LEFT ENGINE	
20	31226-005	CROSSOVER RIGHT ENGINE	
-	77611	GASKET	
-	16073-004	SUPPORT ASSY LEFT HAND	
-	16073-005	SUPPORT ASSY RIGHT HAND	
-	31215-000	ENGINE MOUNT LEFT ENGINE <a href="#">SL462</a>	
-	31215-001	ENGINE MOUNT RIGHT ENGINE <a href="#">SL462</a>	
-	33261-000	ENGINE MOUNT LEFT ENGINE	
-	33261-001	ENGINE MOUNT RIGHT ENGINE	A
-	33261-047	ENGINE MOUNT RIGHT ENGINE	B
-	J-9612-8	SHOCK MOUNT 4 PER ENGINE	
-	J-7763-1	SHOCK MOUNT 4 PER ENGINE	
-	31214-009	INDUCTION AIR BOX BOTTOM	
-	32215-000	INDUCTION AIR BOX TOP	C
-	VARIOUS	SEAT BASE	

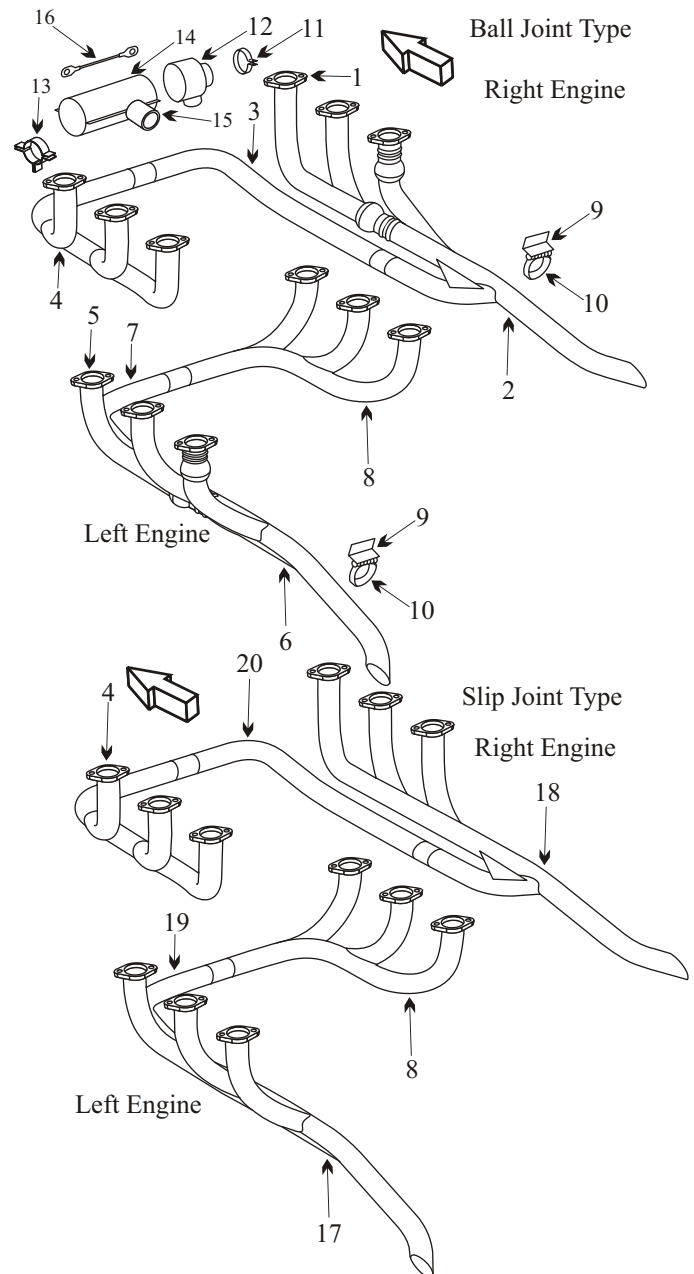

### AD 68-07-04

Applies to S/N's 27-2505 and on, with engine mount P/N 31215-000 & 31215-001  
Inspect engine mount for cracks.  
Inspection required for every 50 hrs of operation after 1000 hrs time in service.

### AD 72-14-05

Applies to S/N's 27-2505 and on, non-turbocharged.  
Inspect exhaust system for cracks, flaking, burning, distortion and leaks.  
Replace parts if defects found.  
Adjust and align as per Piper SB 319.  
Inspection required every 100 hrs of operation.

- Inspect joints for freedom of movement and distortion.
- Inspect the Y-joint at the aft cylinder stack for cracks.
- Inspect for clearance around the front crossover. This area is usually tight but should not be rubbing on the cowling.
- SL462 Prohibits the repair and re-installation of Engine Mounts 31215-000 and 001.

### Usable on Codes

- A: Use engine mount PN 33261-001  
SN 27-2505 to 27-7854050
- B: Use on SN 27-7054051 and on  
Can go down to SN 27-7654001  
if dual pump kit 763 836 installed  
as per service letter No.351
- C: For AC with SN 27-2505 to 275-3275  
Be sure alternate air mod kit #757 021  
has been installed as per SB No. 230A
- D: SN 27-2505 to 27-8054019
- E: SN 27-8054020 and on