



Exhaust Systems Engine Mounts Carb Air Boxes

Shrouds • Seats • Piston • Turbine • Radial • Vintage • And More...



BEECHCRAFT BARON 55/58 WITH 2" ATTACHED TAILPIPE

SN C2058-C2437 SN C2439-C2442 SN E1079-E1198 SN H0741-H1328 SN H1330-H1335

Item	Part Number	Description
1	96-950002-33	STACK RIGHT HAND FWD CYL #5
2	58-950000-7	STACK RIGHT HAND CTR CYL #3
3	58-950002-9	STACK LEFT HAND FWD CYL #6
4	58-950000-5	STACK LEFT HAND CTR CYL #4
5	58-950000-9	TAILPIPE RIGHT ENGINE OB CYL #1
6	58-950000-11	TAILPIPE RIGHT ENGINE IB CYL #2
7	58-950000-13	TAILPIPE LEFT ENGINE IB CYL #1
7	96-324101-11	TAILPIPE LEFT ENGINE IB CYL #1-EGT
8	58-950000-9	TAILPIPE LEFT ENGINE OB CYL #2
8	96-324101-12	TAILPIPE LEFT ENGINE OB CYL #2-EGT
9	96-950002-47	STACK ASSY STUB
-	58-950000-33	CLAMP TAILPIPE
-	628260	GASKET
-	VARIOUS	SEAT BASE
-	VARIOUS	STEP ASSY

Beech 58/58A

Applies to S/N's TH-1 thru TH-1610.

Inspect engine mount for cracks.

Inspection required every 100 hrs of operation till mount repaired with Beech Kit 58-9007-1S or replaced with P/N 96-910010-67 or 96-910010-85

AD 91-15-20

Beech C55/D55/E55

Applies to S/N TC350 and S/N's TE-1 thru TE-1201

Right Engine

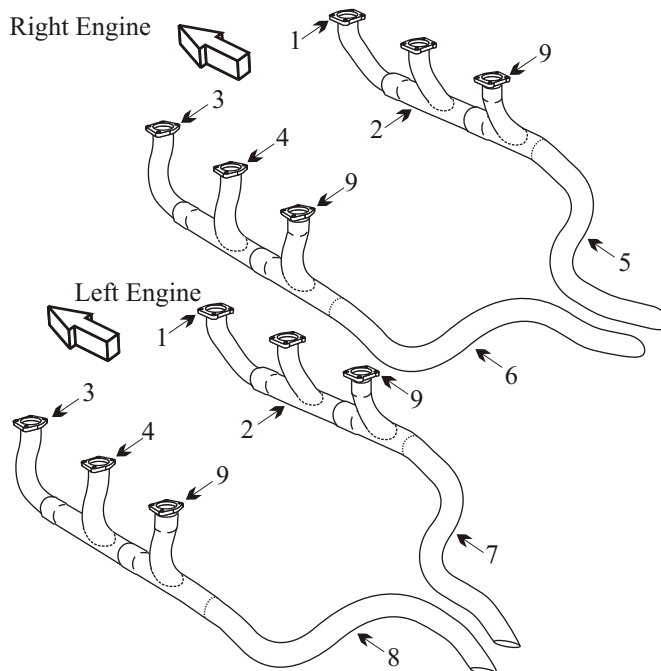

- Inspect joints for freedom of movement and distortion.
- Inspect tailpipe for thinning and internal corrosion.
- Slip fit stacks should be ordered as a complete assembly to ensure good joint integrity with smooth slip fits.

(toll free) 1-888-388-8803 1-780-447-5955 Fax: 1-780-447-5980
 sales@acornwelding.com parts@acornwelding.com www.acornwelding.com