



Exhaust Systems Engine Mounts Carb Air Boxes

Shrouds • Seats • Piston • Turbine • Radial • Vintage • And More...



PIPER PA-42-720 CHEYENNE III WITH P&W PT6A-41-61 ENGINE

Item	Part Number	Description	Code
1	566066-2	EXHAUST OUTLET NOZZLE RH / LH	A
1	74925-008	EXHAUST OUTLET NOZZLE RH / LH	C
2	74925-011	EXHAUST OUTLET NOZZLE RH	B
-	74888-002	ENGINE MOUNT	
-	VARIOUS	SEAT BASE	

Usable on Codes

A: SN 42-7800001 to 42-8001106

B: PN 74925-008 is used on either left hand or right hand, however, PN 74925-011 was later developed for right hand side to reduce undesired temperatures on de-ice boots especially in ground run-ups & training. The stack is rotated 6 degrees upward on PN 74925-011

C: SN 42-8301001 and on

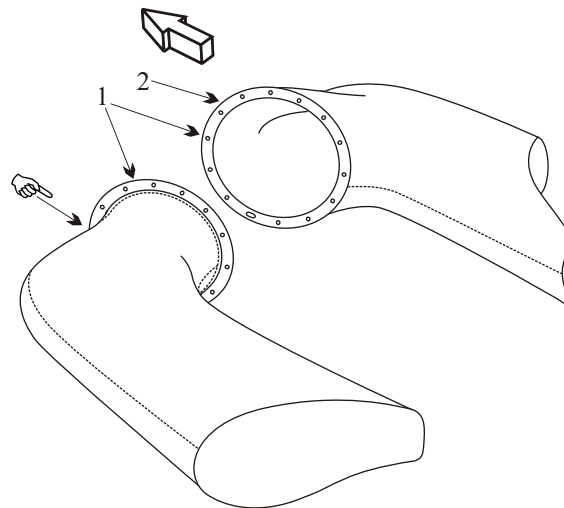

Inspect exhaust where flanges attaches. The exhaust nozzle usually cracks from the inside in this area.

(toll free) 1-888-388-8803 1-780-447-5955 Fax: 1-780-447-5980
 sales@acornwelding.com parts@acornwelding.com www.acornwelding.com